

LEGEND:

- WM — EXISTING TRUNK WATERMAIN
- SW — EXISTING WATERMAIN & PIPE SIZE
- ESV — EXISTING SURFACE WATER PIPE
- EH — EXISTING SLUICE VALVE
- EH — EXISTING HYDRANT
- EOH — EXISTING DUCK FOOT HYDRANT
- HP — PROPOSED 250mm HDPE WATERMAIN
- LP — PROPOSED 100mm HDPE WATERMAIN
- HP 730 — PROPOSED HYDRANT
- HP 7733 — PROPOSED SLUICE VALVE
- HP 730 — PROPOSED SCOUR VALVE
- HP 7733 — PROPOSED AIRVALVE
- HP 730 — PROPOSED BULK WATER METER TO IRISH WATER REQUIREMENTS
- HP 7733 — INDICATES ROAD LOW POINT
- HP 730 — INDICATES NEW SURFACE WATER MANHOLE TO BE BUILT OPPOSITE SCOUR VALVE

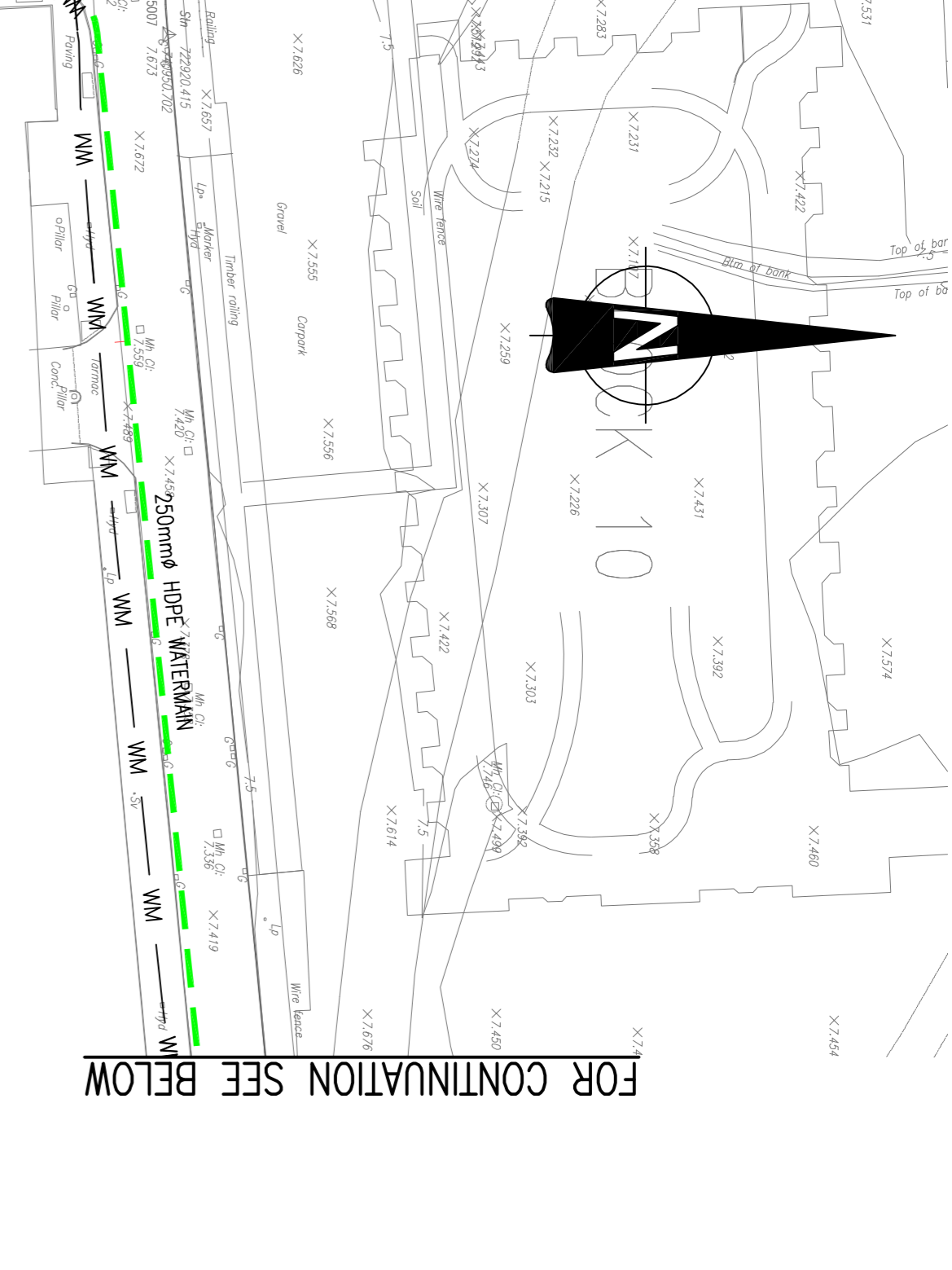

- NOTES:**
- DO NOT SCALE. USE FIGURED DIMENSIONS ONLY.
 - THIS DRAWING IS TO BE READ IN CONJUNCTION WITH ALL OTHER RELEVANT ARCHITECTURAL AND ENGINEERING DRAWINGS.
 - ALL PIPE MATERIALS SHALL BE IN ACCORDANCE WITH SECTION 3.9 OF THE IRISH WATER CODE OF PRACTICE FOR WATER INFRASTRUCTURE. WATERMANS SHALL BE EITHER DUCTILE IRON (DI) OR POLYETHYLENE (PE), WITH PE80 OR PE100 RATING (HDPE, HDPEOR HPPE). ALL PLASTIC WATER PIPES SHALL BE BLUE IN COLOUR.
 - ALL SERVICE CONNECTIONS TO BE 25# HDPE(SR-17).
 - ALL WATERMANS UNDER ROADS OR AT ROAD CROSSINGS TO BE HDPE OR DUCTILE IRON.
 - HOPE DISTRIBUTION PIPES TO BE PE-100(SR-17).
 - DUCTILE IRON PIPES TO IS EN 545 WITH C40 POWER RAINING.
 - AIR VALVE AND HYDRANTS COVERS, WHERE LOCATED IN GRASS AREAS, SHALL BE SURROUNDED BY A CONCRETE PLINTH, 200mm ALL ROUND AND 100mm DEEP FORMED WITH C20/25 CONCRETE, 20mm AGGREGATE SIZE, STEEL IN CLAUSE 804 MATERIAL. THE PLINTH SHALL INCORPORATE WILD BEDDING REINFORCED LINKS AND SHALL HAVE BUILT-IN FINISH AROUND ITS EXTERNAL PERIMETER.
 - THRUST BLOCKS SHALL BE PROVIDED AT EACH BEND ALONG THE COURSE OF THE WATERMAIN.
 - PLAYING ADJACENT TO WATER INFRASTRUCTURE SHALL COMPLY WITH IRISH WATER STANDARD DETAIL STD-W-12X.
 - HORIZONTAL AND VERTICAL CLEARANCE DISTANCES SHALL BE AS PER IRISH WATER STANDARD DETAIL STD-W-11.
 - IT IS THE CONTRACTOR'S RESPONSIBILITY TO ENSURE THAT ALL WORKS ARE CONSTRUCTED IN ACCORDANCE WITH THE IRISH WATER CODE OF PRACTICE AND STANDARD DETAILS. THE CODE OF PRACTICE AND STANDARD DETAILS ARE AVAILABLE TO DOWNLOAD FROM THE IRISH WATER WEB SITE AT WWW.WATER.IE/CONNECTIONS/AVAILABLE-SERVICES/ WHERE THE DETAILS CONTAINED ON THIS DRAWING DIFFER FROM THE IRISH WATER CODE OF PRACTICE OR STANDARD DETAILS THIS MUST BE BROUGHT TO THE ATTENTION OF THE ENGINEER IMMEDIATELY. IRISH WATER STANDARDS WILL TAKE PRECEDENCE.

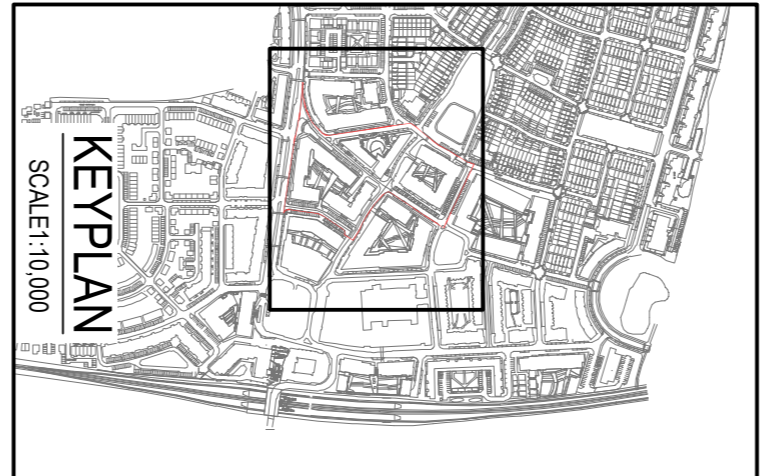

Ordnance Survey Ireland Licence No. EN 0006019
© Ordnance Survey Ireland/Government of Ireland.

Waterman Moylan
Engineering Consultants
BLOCK 5, EASTPOINT BUSINESS PARK, ALFIE BRYNE ROAD,
DUBLIN D08 H9F4 IRELAND. TEL: 011 964 8800
Email: info@waterman-moylan.ie www.waterman-moylan.ie

GERARD GANNON PROPERTIES
ARCHITECT CONROY CROWE KELLY

CONGRIFIN SHD APPLICATION 2

DRAWN	DESIGNED	APPROVED	DATE
PJD	MD	MD	NOV 18'
SCALE	JOB NO.	PRG. NO.	REVISION
1:500 @ A1	18-059	2300	A

FOR PLANNING NOT FOR CONSTRUCTION

STATUS	REV. DATE	DESCRIPTION	BY	APP'D
A	12/6/19	REVISED FOR FINAL SUBMISSION	PJD	MD
B		AMENDMENT	DRN	APPD

1:1 0 10 20 30 40 50 60 70 80 90 100 50.0m